

TD Series LVDT

(Displacement Transducer)

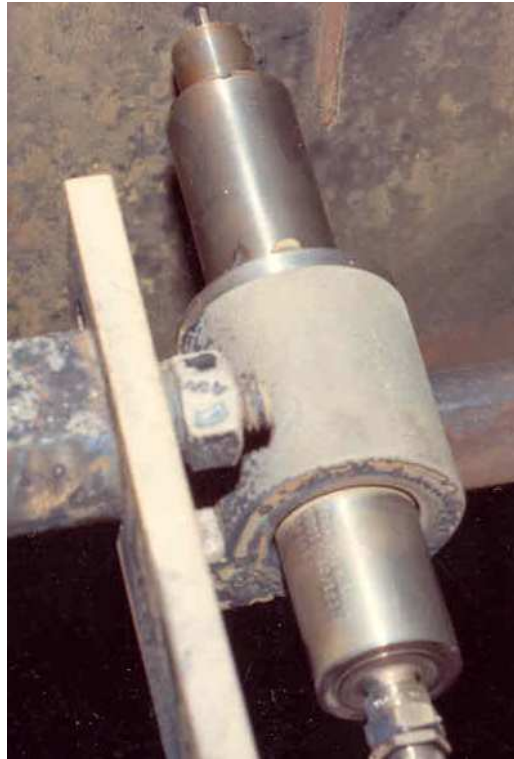

- Designed for severe environments
- Spring loaded design
- AC Input, AC output
- Connector cable or conduit outlets
- Stainless Steel body
- 20 to 150°C (220°C version available)

The TD series LVDTs are designed to be used in severe environments where only a very robust displacement transducer will survive.

The TD series LVDT has a stainless steel body and a heavy duty stainless steel spring loaded core.

The transducer input and output connections are via either a connector, cable or conduit.

If moisture is present then a connector or cable version only gives limited protection whilst the conduit version enables the transducer to be fully submersed.

If the TD is to be submersed please indicate the depth and fluid the LVDT is to be used in so that tests (with the appropriate safety factors) can be carried out on the unit prior to despatch.

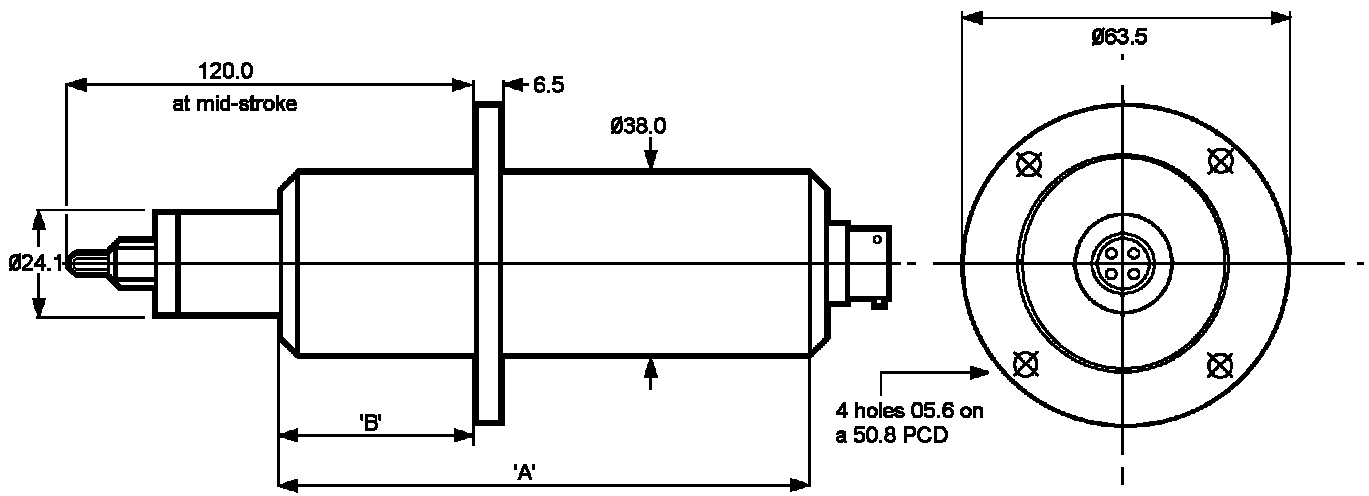

Version 1 (TDXX/1)

Spring loaded, captive core and extension rod. End exit with 4 pin connector. Weatherproof (IP55)

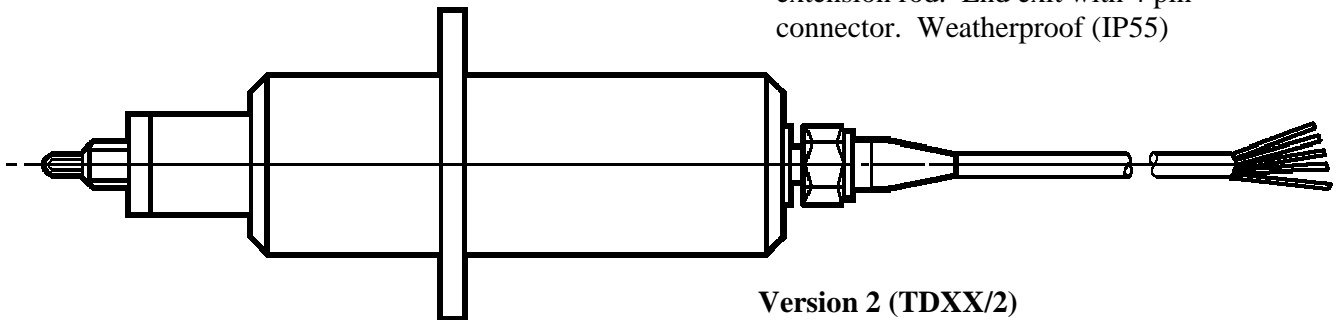

Version 2 (TDXX/2)

Spring loaded, captive core and extension. End exit via 4 core PTFE cable 2m in length. Other lengths optional. Weather proof (IP55).

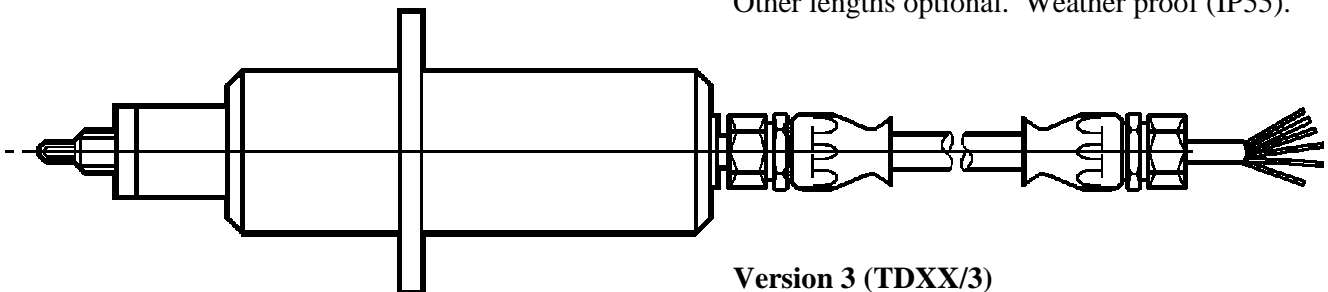

Version 3 (TDXX/3)

Spring loaded, captive core and extension rod. End exit via 4 core PTFE cable in stainless steel braided flexible conduit, ending in 1/4 BSP re-usable coupling, 2m in length, other lengths optional. Weatherproof (IP155) or submersible version.

DS1189-1



Sensonics Ltd,
 Berkhamsted,
 Hert's, HP4 1EF,
 England
 Tel: +44(0) 1442 876 833.
 Fax: +44(0) 1442 876 477.